

GENERAL NOTES:

1. THE OWNER'S PROFESSIONAL ENGINEER IS REQUIRED TO INSPECT THE INSTALLATION OF SERVICES AND FINAL GRADING INCLUDED IN THIS PROJECT IN ACCORDANCE WITH THE GENERAL REVIEW COMMITMENT CERTIFICATION PROCESS. THE OWNER'S CONTRACTOR IS TO PROVIDE AT LEAST 48 HOURS PRIOR TO ANY REQUIRED ONSITE REVIEW.
2. THE OWNER/CONTRACTOR SHALL HAVE ITS PROFESSIONAL ENGINEER PROVIDE FULL-TIME ONSITE REVIEW DURING CONSTRUCTION ON AN EXISTING MUNICIPAL STREET OR EASEMENT AND PROVIDE A CERTIFICATE OF COMPLETION OF WORKS UPON COMPLETION OF ALL WORKS TO BE CONSTRUCTED.
3. ALL OFF-SITE WORK SHALL BE DONE IN ACCORDANCE WITH THE MINIMUM STANDARDS AND SPECIFICATIONS OF THE MUNICIPALITY AND ALL ON-SITE WORK PER THE CURRENT EDITION OF THE ONTARIO BUILDING CODE AND ANY APPLICABLE STATUTES, REGULATIONS, CODES AND BY-LAWS.
4. SBM LTD. IS NOT RESPONSIBLE FOR THE INFORMATION (EXISTING TOPOGRAPHY, BENCHMARKS, PROPERTY BOUNDARY, ETC.) PROVIDED BY OTHERS.
5. ALL WORK AND CONSTRUCTION OF ANY REQUIRED UTILITY WORK (SHOWN ON THESE PLANS OR NOT) IS BY OTHERS. STRIK BALDINELLI MONIZ LTD. DESIGN AND DRAWINGS ARE FOR MUNICIPAL (WATER, SANITARY, AND STORM WATER) SERVICING AND GRADING ONLY. ANY UTILITY INFORMATION SHOWN IS FOR REFERENCE/COORDINATION PURPOSES ONLY AND MAY NOT BE ACCURATE.

CONSTRUCTION NOTES:

1. REFER TO THE SITE PLAN FOR LAYOUT DIMENSIONING AND SIGN/POST DETAILS.
2. THE OWNER'S CONTRACTOR IS TO CONTACT THE CONSULTING ENGINEER FOR FINAL ONSITE REVIEW.
3. THE OWNER'S CONTRACTOR SHALL TAKE ALL PRECAUTIONARY MEASURES UNDER THE OCCUPATIONAL HEALTH AND SAFETY ACT AS REQUIRED BY THE MINISTRY OF LABOUR.
4. THE OWNER'S CONTRACTOR IS TO REVIEW AND CONFIRM ALL EXISTING CONDITION INFORMATION & INFORM STRIK, BALDINELLI, MONIZ LTD. (SBM) OF ANY DISCREPANCIES PRIOR TO CONSTRUCTION. SBM IN NO WAY ACCEPTS RESPONSIBILITY FOR ANY INACCURACIES FOUND ON THIS PLAN RELATIVE TO EXISTING CONDITIONS FOR THE SITE.
5. PRIOR TO COMMENCING ANY CONSTRUCTION, ALL SEWER OUTLET INFORMATION, BENCHMARKS, ELEVATIONS, DIMENSIONS, GRADES, ETC. MUST BE CHECKED BY THE OWNER'S CONTRACTOR AND VERIFIED AND ANY DISCREPANCIES REPORTED TO THE CONSULTING ENGINEER.
6. PRIOR TO COMMENCING ANY WORK ON THE INSTALLATION OF SERVICES & GRADING, AN APPROVED SET OF PLANS AND SPECIFICATIONS MUST BE AVAILABLE ON THE JOB AND SHALL REMAIN ON THE JOB WHILE WORK IS BEING DONE.
7. STRIP FULL DEPTH OF TOPSOIL IN AREAS TO BE DISTURBED AND STOCK PILE FOR RE-USE IN GRASSED/LANDSCAPED AREAS.
8. OWNER'S CONTRACTOR IS RESPONSIBLE FOR ALL AS-BUILT INVERTS AND GRADES, RECORD ANY DEVIATION OF PIPE OR STRUCTURE LOCATION INVOLVED WITH THIS PROJECT AND OWNER'S CONTRACTOR TO PROVIDE A COPY OF THE AS-BUILT DRAWING SHOWING ALL CHANGES CLEARLY MARKED IN RED.
9. THE OWNER'S CONTRACTOR SHALL CONSTRUCT TEMPORARY MEASURES TO CONTROL SILT ENTERING THE STORM DRAINAGE SYSTEM TO THE SPECIFICATIONS OUTLINED IN THE GUIDELINES ON EROSION AND SEDIMENT CONTROL FOR URBAN CONSTRUCTION SITES PREPARED BY THE MINISTRY OF NATURAL RESOURCES. THESE MEASURES ARE TO BE INSTALLED PRIOR TO COMMENCING ANY CONSTRUCTION FOR THIS PROJECT AND ARE TO REMAIN IN PLACE UNTIL CONSTRUCTION HAS BEEN COMPLETED TO BASE ASPHALT AND SOD OR THE SATISFACTION OF THE MUNICIPALITY'S ENGINEER.
10. THE OWNER'S CONTRACTOR SHALL INFORM THE LOCAL TRANSIT COMMISSION AT LEAST ONE WEEK PRIOR TO COMMENCING CONSTRUCTION ON ANY STREET THAT IS A PUBLIC BUS ROUTE THAT WILL BE AFFECTED BY CONSTRUCTION.
11. THE OWNER'S CONTRACTOR IS RESPONSIBLE FOR:
- 11.1. CONNECTING ANY EXISTING SEWER OR DRAIN ENCOUNTED DURING CONSTRUCTION TO A NEW SEWER OF SIMILAR TYPE, SIZE AND MATERIAL OR INTO ANOTHER EXISTING SEWER OF THE SAME TYPE.
- 11.2. ENSURING THAT THERE IS NO INTERRUPTION OF ANY SURFACE OR SUBSURFACE DRAINAGE FLOW THAT WOULD ADVERSELY AFFECT NEIGHBOURING PROPERTIES.
12. NO FOUNDATION DRAIN CONNECTIONS WILL BE PERMITTED INTO THE SANITARY SEWERS AND NO DIRECT GRAVITY CONNECTIONS FROM THE FOUNDATION DRAINS WILL BE PERMITTED TO THE STORM SYSTEM UNLESS THE STORM SYSTEM HAS THE CAPACITY TO PROVIDE FOR SUCH CONNECTIONS TO THE SATISFACTION OF THE MUNICIPALITY'S ENGINEER.
13. WORK ON OR ADJACENT TO THE MUNICIPAL R.O.W. SHALL BE COMPLETED IN ACCORDANCE WITH THE ONTARIO TRAFFIC MANUAL BOOK 7 CURRENT EDITION.

SURFACE WORKS NOTES:

1. ALL WORK IN THE MUNICIPAL ROAD ALLOWANCE SHALL MEET THE MINIMUM STANDARDS AND SPECIFICATIONS UNLESS OTHERWISE APPROVED BY THE MUNICIPALITY'S ENGINEER. THE OWNER'S CONTRACTOR IS REQUIRED TO OBTAIN & PAY FOR PERMIT TO WORK IN MUNICIPAL R.O.W., IF REQUIRED.
2. ALL SURFACES WHICH ARE DISTURBED DURING CONSTRUCTION SHALL BE RESTORED TO A CONDITION AT LEAST AS GOOD AS ORIGINAL, OR AS PER BELOW (WHICHEVER IS GREATER) OR IF WITHIN THE MUNICIPAL RIGHT-OF-WAY TO THE SATISFACTION OF THE MUNICIPAL ENGINEER, ALL AT NO COST TO THE MUNICIPALITY;
- 2.1. GRASSED AREAS TO BE RESTORED w/ 100mm TOPSOIL + SOD.
- 2.2. CONCRETE SIDEWALK TO OPSD 310.010 'CONCRETE SIDEWALK'.
- 2.3. CONCRETE CURB AND GUTTER AS SPECIFIED ON DRAWINGS.
- 2.4. ANY ASPHALT AREA DISTURBED DURING CONSTRUCTION SHALL BE RESTORED AS FOLLOWS:
- 2.4.1. PROOF ROLL SUBGRADE TO THE SATISFACTION OF THE GEOTECHNICAL ENGINEER PRIOR TO PLACEMENT OF GRANULARS (98% SPMD MIN.).
- 2.4.2. MILL ADJACENT ASPHALT TO BE TIED INTO 50mm DEEP x 500mm WIDE PRIOR TO RESTORATION SEE DETAIL ON SHEET C1.
- 2.4.3. MIN. RECOMMENDED ON-SITE HEAVY-DUTY (ROAD) PAVEMENT STRUCTURE (TO BE REVIEWED & APPROVED BY THE GEOTECHNICAL ENGINEER);
- 40mm HL3 SURFACE ASPHALT COMPACTED TO 97% MARSHALL MIX DESIGN BULK DENSITY (TACK COAT REQUIRED PER SUPPLEMENTAL STANDARDS FOR ROADS (310.07.03 IF INSTALLED MORE THAN 2 WEEKS AFTER BINDER ASPHALT)
- 60mm HL8 BINDER ASPHALT COMPACTED TO 97% MARSHALL MIX DESIGN BULK DENSITY
- ASPHALT TO BE SUPPLIED AND PLACED IN ACCORDANCE WITH OPSS 310 & 1150
- 150mm OF GRANULAR 'A' COMPACTED TO 100% SPMD
- 300mm OF GRANULAR 'B' COMPACTED TO 100% SPMD
- 2.4.4. MATCH EXISTING CONDITIONS OR AS PER BELOW IN MUNICIPAL RIGHT-OF-WAY, WHICHEVER IS GREATER;
- 40mm HL3 BASE ASPHALT COMPACTED TO 97% MARSHALL MIX DESIGN BULK DENSITY
- 40mm HL8 SURFACE ASPHALT COMPACTED TO 97% MARSHALL MIX DESIGN BULK DENSITY
- 150mm OF GRANULAR 'A' COMPACTED TO 100% SPMD
- 400mm OF GRANULAR 'B' COMPACTED TO 100% SPMD.
- 2.5. CONCRETE DRIVEWAY STRUCTURE (SUBGRADE TO BE REVIEWED AND APPROVED BY THE GEOTECHNICAL ENGINEER)
- 150mm THICK CAST-IN-PLACE CONCRETE - 35MPa @ 28 DAYS; EXPOSURE CLASS-C-1; ENVIRONMENT-CORROSIVE
- 150mm OF GRANULAR 'A' COMPACTED TO 100% SPMD
- 2.6. RESTORE ALL PAVEMENT MARKINGS TO MATCH EXISTING PRE-CONSTRUCTION CONDITIONS AND MARKINGS SHALL BE COMPLETED IN ACCORDANCE WITH OPSS 710 'CONSTRUCTION SPECIFICATION FOR PAVEMENT MARKING'.
- 2.7. ALL EXTERIOR HORIZONTAL CONCRETE SHALL BE 32 MPa @ 28 DAYS c/w 5-8% AIR ENTRAINMENT.
3. ALL AREAS OUTSIDE THE CONSTRUCTION LIMITS SHALL NOT BE DISTURBED. ANY DAMAGED TO THOSE AREAS ARE TO BE REPAIRED AT THE CONTRACTORS EXPENSE TO THE EXISTING CONDITIONS, OR ABOVE NOTED SPECIFICATIONS, WHICHEVER IS GREATER.

UTILITIES NOTES:

1. THE UTILITIES PROVIDERS MUST BE INFORMED AT LEAST TWO WEEKS PRIOR TO CONSTRUCTION ON ANY EXISTING MUNICIPAL ROAD ALLOWANCE. ALL EXISTING UNDERGROUND SERVICE OR UTILITIES WITHIN THE LIMITS OF THE CONSTRUCTION SITE SHALL BE LOCATED AND MARKED. ANY UTILITIES, DAMAGED OR DISTURBED DURING CONSTRUCTION, SHALL BE REPAIRED OR REPLACED TO THE SATISFACTION OF THE GOVERNING BODY AT THE CONTRACTOR'S EXPENSE.
2. ALL EXISTING UNDERGROUND UTILITY (TELEPHONE, HYDRO, GAS, CABLE, SEWER, WATERMAINS, ETC.) THAT WILL BE CROSSED UNDER DURING THE INSTALLATION OF SERVICES FOR THIS DEVELOPMENT SHALL BE SUPPORTED, AS MAY BE REQUIRED BY THE OWNERS OF THE UTILITY BEING CROSSED UNDER.
3. OWNER'S CONTRACTOR TO VERIFY LOCATION OF ALL EXISTING UTILITIES PRIOR TO CONSTRUCTION.
4. OWNER'S CONTRACTOR TO COORDINATE WITH UTILITIES PROVIDER FOR BRACING, DECOMMISSIONING AND/OR RELOCATION OF EXISTING GAS, HYDRO, TELEPHONE, CABLE, ETC. SERVICES, IF REQUIRED.

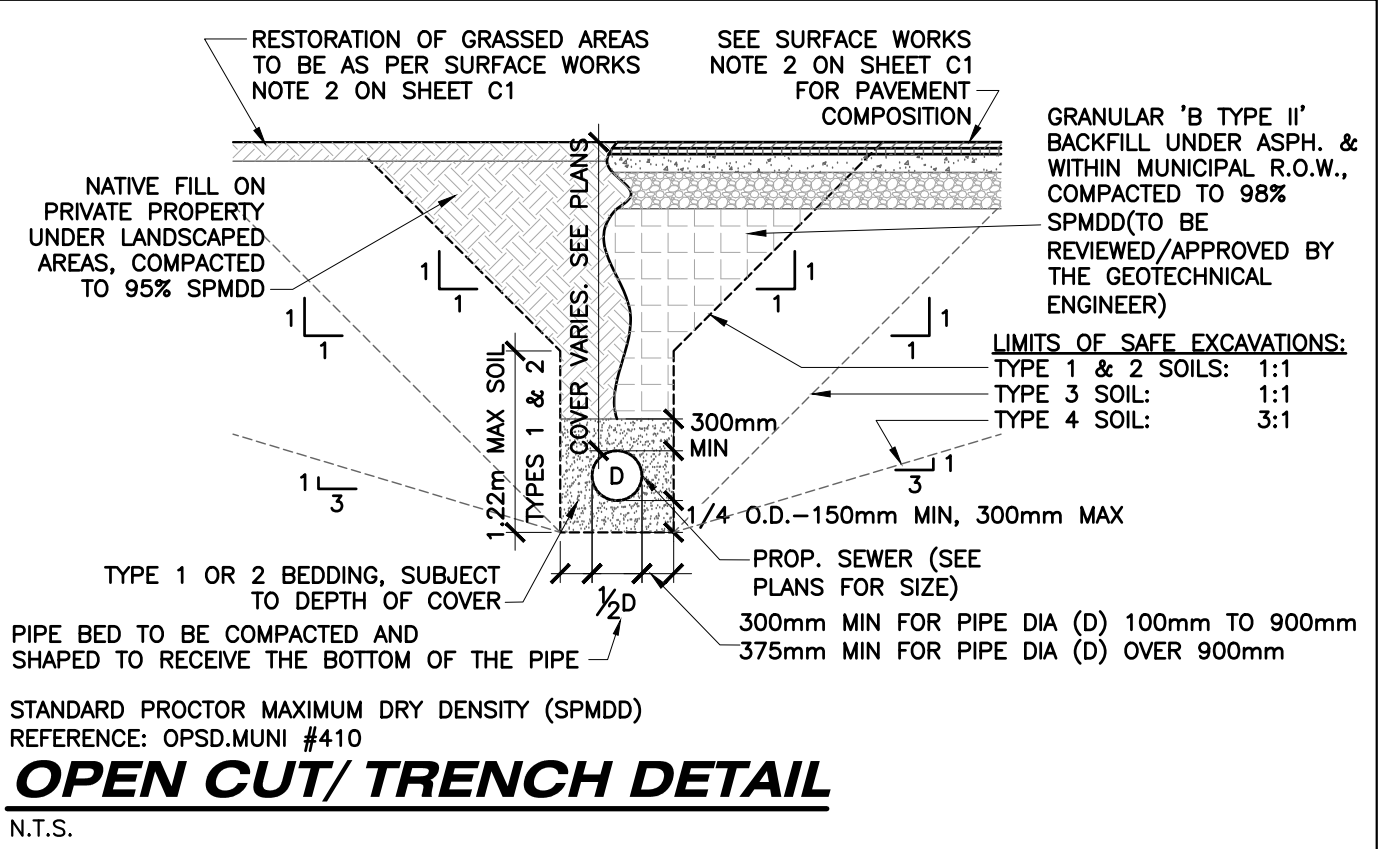

SERVICING NOTES:

1. ALL STORM AND/OR SANITARY SEWER INSTALLATION SHALL BE IN ACCORDANCE WITH THE CURRENT MUNICIPAL STANDARDS AND THE CURRENT EDITION OF THE ONTARIO BUILDING CODE.
2. ALL SITE SERVICES SHALL BE INSTALLED TO 1.0m OUTSIDE FOUNDATION WALL.
3. ALL ORGANIC, UNSTABLE OR UNSUITABLE MATERIALS BENEATH THE ROAD ALLOWANCE, SERVICES, UTILITIES, OR FOUNDATIONS MUST BE REMOVED AND THESE AREAS BACKFILLED WITH AN APPROVED FILL MATERIAL, ALL TO THE SATISFACTION OF A GEOTECHNICAL ENGINEER AND SHOULD BE PLACED IN LIFTS NOT EXCEEDING 300mm (LOOSE) THAT ARE COMPACTED TO 95% SPMD (100% FOR PAVED SURFACES). THE FILL MATERIAL SHOULD COMPRISE OF CLEAN, COMPACTIBLE FILL WITHIN 3% OF THE OPTIMUM MOISTURE CONTENT.
4. REMOVE ALL TRENCH WATER WHEN PIPE LAYING IS IN PROGRESS. ALL REQUIREMENTS FOR Dewatering PERMITS (INCLUDING THE MINISTRY OF ENVIRONMENT CONSERVATION AND PARKS (M.E.C.P.)'S PERMIT TO TAKE WATER, IF REQUIRED) SHALL BE THE RESPONSIBILITY OF THE OWNER'S CONTRACTOR.
5. ALL PROPOSED STORM AND SANITARY SEWER PIPE TO BE PVC DR 35 OR MUNICIPALITY APPROVED PIPE WITH BEDDING TO OPSD 802.010. ALL SEWER BACKFILL MUST BE COMPACTED TO 95% STANDARD MAXIMUM DRY DENSITY (MINIMUM) (100% FOR PAVED AREAS).
6. THE MINIMUM DEPTH OF A STORM SEWER SHALL BE 1.22m FROM THE FINISHED GROUND ELEVATION TO THE CROWN OF THE PIPE AS PER OPSD 3090.101 'FOUNDATION, FROST PROTECTION DEPTHS FOR SOUTHERN ONTARIO' WHERE MINIMUM DEPTHS CANNOT BE ACHIEVED AND THEREFORE FROST PROTECTION IS WARRANTED, INSULATION IS REQUIRED AS PER THE CURRENT EDITION OF THE ONTARIO BUILDING BUILDING CODE.
7. ALL STORM AND SANITARY SEWERS/SERVICES AND CATCHBASIN LEADS SHALL HAVE APPROVED RUBBER GASKET JOINTS + BE INSTALLED USING A LASER LEVEL.
8. OWNER'S CONTRACTOR TO PROVIDE SHOP DRAWINGS FOR ALL PRECAST CONCRETE STRUCTURES.
9. ALL CATCHBASINS AND CATCHBASIN MAINTENANCE HOLES TO HAVE 0.6m SUMPS TYPICAL.
10. 3.0m LENGTHS OF 150mm DIAMETER PERFORATED FILTER WRAPPED PVC PIPE ARE TO BE INSTALLED AS SUBDRAINS CONNECTED TO TWO SIDES OF EACH CATCHBASIN AND CATCHBASIN MAINTENANCE HOLE WITHIN PAVED AREAS. THE SUBDRAINS ARE TO BE LOCATED JUST BELOW SUBGRADE ELEVATION.
11. BUILDING FOOTINGS ARE TO BE STEPPED DOWN (SEE STRUCTURAL DRAWINGS) TO ALLOW SERVICES TO PASS THROUGH THE FOUNDATION WALL NOT UNDER THE FOOTING.
12. MAINTENANCE HOLES TO BE CONSTRUCTED OF PRE-CAST CONCRETE. ALL MAINTENANCE HOLES TO BE INSTALLED IN ACCORDANCE WITH THE ONTARIO PROVINCIAL STANDARDS (OPSD) DIVISION 700 DETAILS AND REQUIREMENTS; SEE LIST OF COMMON DETAILS.
13. THE MAXIMUM DISTANCE BETWEEN FINISHED GRADE AND FIRST MAINTENANCE HOLE LADDER RUNG TO BE NO MORE THAN 600mm.
14. ALL WATERMAIN PIPE OVER 300mm Ø TO BE POLYVINYL CHLORIDE (PVC) C905, CLASS 165, DR25. ALL WATERMAIN UP TO AND INCLUDING 300mm Ø SHALL BE POLYVINYL CHLORIDE (PVC) C900, CLASS 150, DR18. DUCTILE IRON (DI) CL15 AND RESPECTIVELY CL52 c/w POLYETHYLENE WRAP MAY BE USED IF APPROVED BY THE MUNICIPALITY.
15. WHERE ANY WATER SERVICE CONNECTION IS REQUIRED TO BE MADE FOLLOWING THE CONSTRUCTION OF CURB, GUTTER, CONCRETE SIDEWALKS, AND/OR WEARING SURFACE COAT OF ASPHALT ON ANY STREET IN A NEW SUBDIVISION, SUCH WATER SERVICE CONNECTION SHALL NOT BE MADE USING 'OPEN CUT' METHODS BUT SHALL BE MADE USING TRENCHLESS TECHNOLOGIES AND IN SUCH A MANNER AS TO ELIMINATE THE POSSIBILITY OF SETTLEMENT OF SUCH CURB, GUTTER, CONCRETE SIDEWALKS AND/OR WEARING SURFACE COAT OF ASPHALT; IT BEING UNDERSTOOD THAT THIS POLICY SHALL APPLY, EXCEPT WHERE IN THE OPINION OF THE MUNICIPALITY'S ENGINEER, GROUND CONDITIONS ARE SUCH THAT THE USE OF DRILLING OR BORING METHODS BECOME UNREASONABLE OR UNECONOMICAL.
16. ALL WATERMAIN MATERIAL AND CONSTRUCTION SHALL CONFORM TO THE CURRENT MUNICIPAL STANDARDS.
17. ALL FIRE HYDRANTS SHALL BE 3-WAY HYDRANTS c/w STORZ CONNECTION OPENING COUNTER CLOCKWISE AS PER THE MUNICIPALITY'S STANDARDS.
18. ALL WATERMAIN VALVES SHALL BE GATE VALVES MANUFACTURED TO AWMA C500 AND EPOXY COATED TO AWMA C550 AND ARE TO OPEN COUNTER CLOCKWISE.
19. INSTALLATION, HYDROSTATIC TESTING, SWABBING, FLUSHING AND DISINFECTION SHALL BE DONE IN ACCORDANCE WITH THE MUNICIPAL STANDARDS.
20. ALL NON-METALLIC WATER PIPE TO BE INSTALLED c/w 10AWG TRACER WIRE AS PER OPSS SECTION 441.07.15.
21. SEPARATION BETWEEN BURIED WSC & PDC AS PER M.E.C.P. GUIDELINES AND SECTION 7.3.5.7. OF THE O.B.C.
22. WATER SERVICE TO BE PEX AND ALL WATER PIPE TO HAVE TRACER WIRE. WATERMAIN TO BE INSTALLED WITH 1.5m COVER. PEX WATER SERVICE REQUIRES BRASS FITTINGS. PROVIDE PIPE RESTRAINTS AS REQUIRED BY THE PIPE MANUFACTURER.
23. WHEN CROSSING ABOVE A SANITARY/STORM SEWER THE OWNER'S CONTRACTOR IS TO ENSURE A MINIMUM 0.5m VERTICAL SEPARATION FROM THE UNDERSIDE OF THE WATER SERVICE TO THE CROWN OF THE SEWER AS OUTLINED IN THE CURRENT EDITION OF THE M.E.C.P. "DESIGN GUIDELINES FOR DRINKING-WATER SYSTEMS" AND INSULATE WATER SERVICE AS PER CLAUSE 7.3.5.4. 'PROTECTION FOR FROST' OF THE CURRENT EDITION OF THE ONTARIO BUILDING CODE, WHERE REQUIRED.
24. ALL SUBSTITUTIONS MUST BE APPROVED BY THE MUNICIPALITY'S ENGINEER.
25. THE ELEVATION OF THE GROUND WATER TABLE IS UNKNOWN. CONTRACTOR TO ADVISE SBM IF GROUNDWATER IS ENCOUNTERED DURING EXCAVATION OPERATIONS; FURTHER REVIEW/INVESTIGATION BY A GEOTECHNICAL ENGINEER MAY BE REQUIRED. IF GROUNDWATER IS ENCOUNTERED DURING EXCAVATION OPERATIONS, CIVIL STRUCTURES ARE TO BE DESIGNED FOR HYDROSTATIC PRESSURE AND UPLIFT/BUOYANCY FORCES. PROVIDE SHOP DRAWINGS SEALED BY A PROFESSIONAL ENGINEER LICENSED IN THE PROVINCE OF ONTARIO FOR REVIEW.

LIST OF STANDARD DETAILS:

ONTARIO PROVINCIAL STANDARDS:	
OPSD 219.110	LIGHT-DUTY SILT FENCE BARRIER
OPSD 219.180	STRAW BALE FLOW CHECK DAM
OPSD 310.010	CONCRETE SIDEWALK
OPSD 310.020	CONCRETE SIDEWALK ADJACENT TO CURB AND GUTTER
OPSD 351.010	URBAN RESIDENTIAL ENTRANCES
OPSD 401.010	CAST IRON, SQUARE FRAME WITH CIRCULAR CLOSED OR OPEN COVER FOR MAINTENANCE HOLES
OPSD 401.020	CAST IRON, CIRCULAR FRAME WITH CIRCULAR 745mm COVER FOR MAINTENANCE HOLES
OPSD 600.060	CONCRETE SEMI-MOUNTABLE CURB WITH STANDARD GUTTER
OPSD 608.010	METHOD OF TERMINATION, FOR CONCRETE CURB AND GUTTER
OPSD 701.010	PRECAST CONCRETE MAINTENANCE HOLE, 1200mm DIAMETER
OPSD 705.010	PRECAST CONCRETE CATCH BASIN, 600mmx600mm
OPSD 802.095	TRENCH PLUG
OPSD 1109.011	CATHODIC PROTECTION FOR PVC WATERMAIN SYSTEMS
OPSD 1109.030	INSULATION FOR SEWERS AND WATERMAINS IN SHALLOW TRENCHES

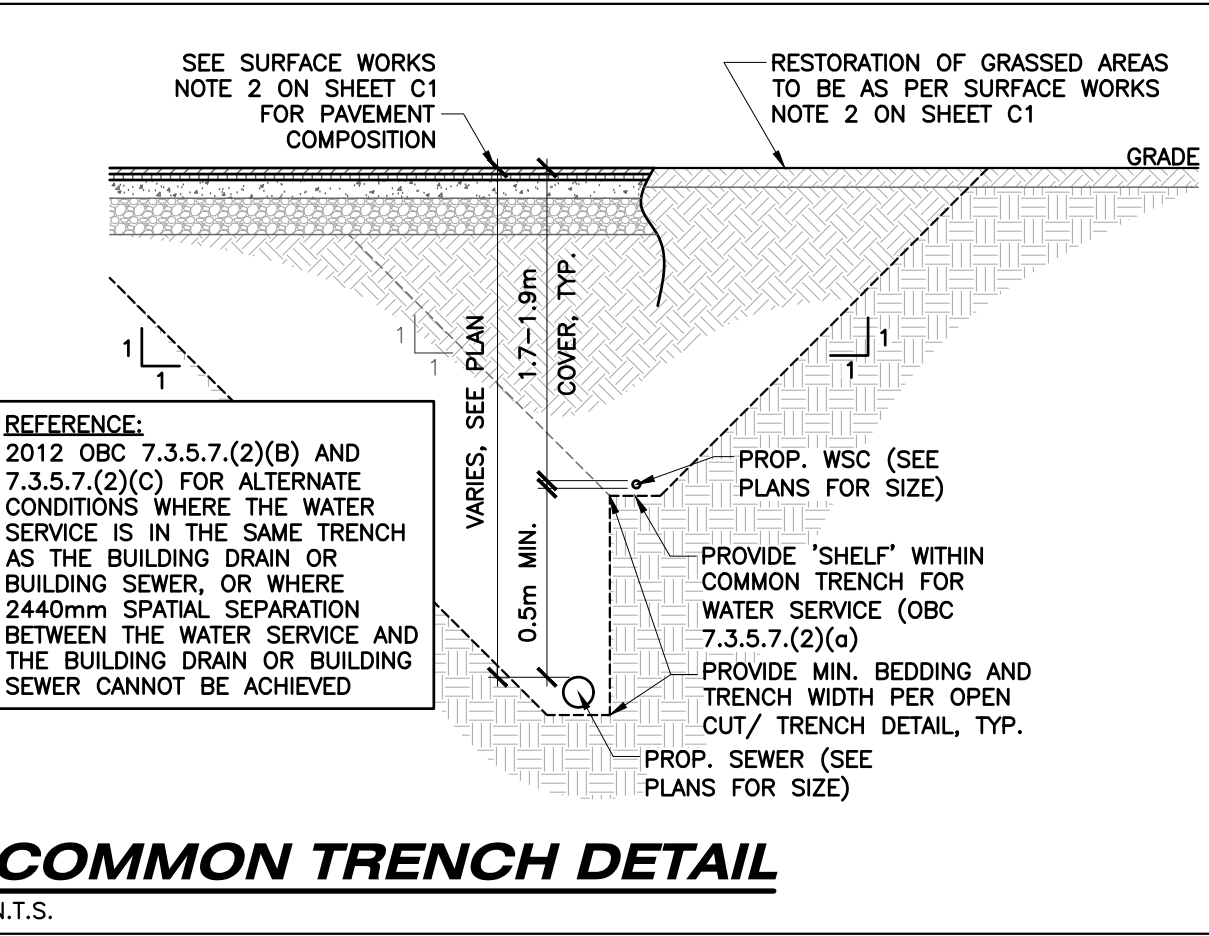

COMMON TRENCH DETAIL N.T.S.

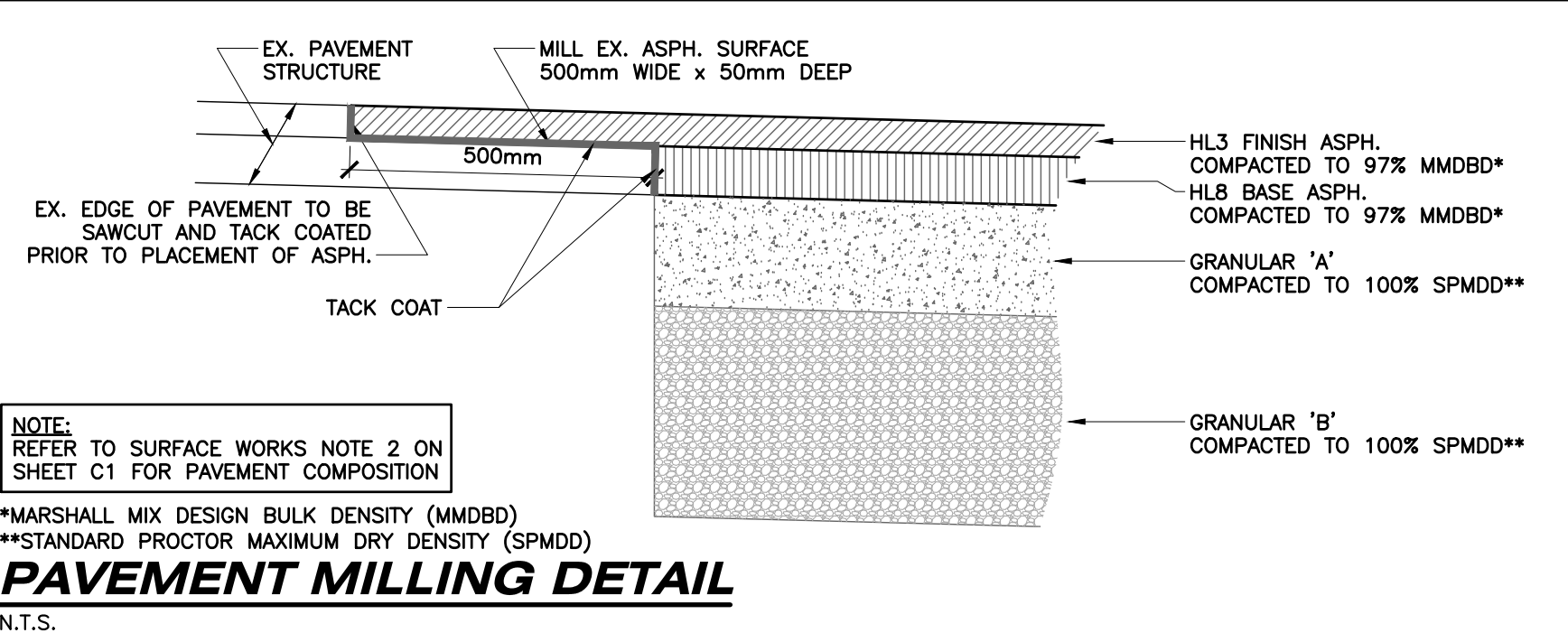

NOTE:
REFER TO SURFACE WORKS NOTE 2 ON SHEET C1 FOR PAVEMENT COMPOSITION

*MARSHALL MIX DESIGN BULK DENSITY (MMDDB)
**STANDARD PROCTOR MAXIMUM DRY DENSITY (SPMD)

PAVEMENT MILLING DETAIL N.T.S.

LEGAL INFORMATION

PART OF
LOT 30
CONCESSION 14
IN THE
MUNICIPALITY OF
LAMBTON SHORES
(TOWN OF FOREST)
COUNTY OF LAMBTON

SITE BENCHMARK#1:

MONUMENT TYPE: TOP SPINDLE OF FIRE HYDRANT.

LOCATION: NORTHEAST CORNER OF SITE ALONG CLYDE STREET.

GEODETIC ELEVATION: 216.14

(CONTRACTOR TO CONFIRM BENCHMARK ELEVATIONS)

SITE BENCHMARK#2:

MONUMENT TYPE: TOP SPINDLE OF FIRE HYDRANT.

LOCATION: NORTHWEST CORNER OF SITE AT CORNER OF CLYDE STREET & ARGYLE STREET.

GEODETIC ELEVATION: 213.72

(CONTRACTOR TO CONFIRM BENCHMARK ELEVATIONS)

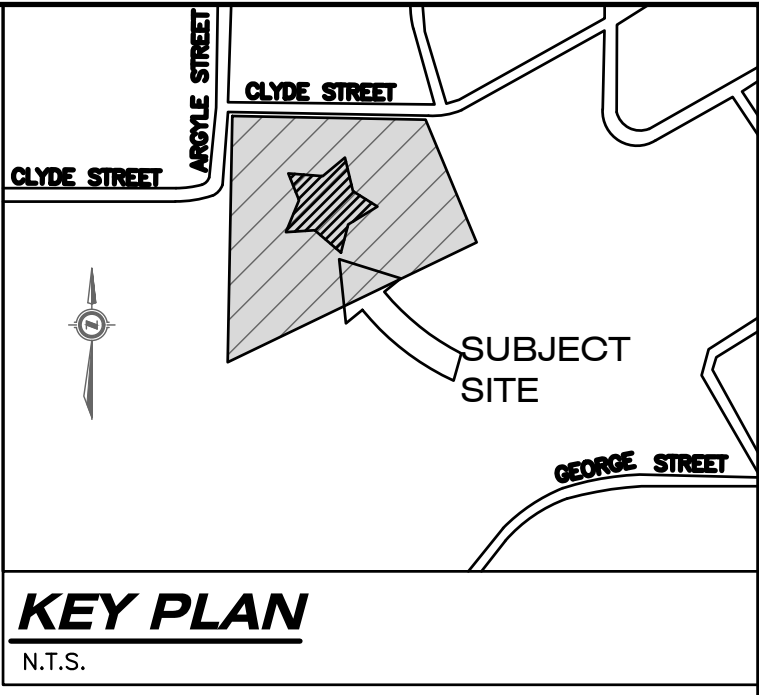

KEY PLAN

N.T.S.

LIST OF ITEMS REQUIRING ENGINEER'S REVIEW

NOTE: CONTRACTOR TO PROVIDE MIN. 48 HOURS NOTICE PRIOR TO REQUESTED FIELD REVIEW TIME.
EROSION AND SEDIMENT CONTROL MEASURES, UPON COMPLETION
SERVICING IN MUNICIPAL RIGHT-OF-WAY (R.O.W.), EXISTING AND FUTURE, DURING CONSTRUCTION
GRADING - CURB & GUTTER STRINGLINE, PRIOR TO CURB INSTALLATION
GRADING - ROAD SUBGRADE, PRIOR TO GRANULARS
GRADING - GRANULAR 'B', PRIOR TO GRANULAR 'A'
GRADING - GRANULAR 'A', PRIOR TO BASE ASPHALT
GRADING - BASE ASPHALT, PRIOR TO TOP COAT ASPHALT
GRADING - TOP COAT ASPHALT
GRADING - BOULEVARDS (ROUGH GRADING)
MANDREL, LEAKAGE, AND LOW PRESSURE AIR TESTING (SEWERS) - DURING TEST
WATERMAIN COMMISSIONING, DURING PROCEDURE

LIST OF SUBMITTALS

NOTE: CONTRACTOR TO PROVIDE SHOP DRAWINGS FOR REVIEW PRIOR TO ORDERING MATERIALS.
SHOP DRAWINGS - STORM & SANITARY STRUCTURES
SHOP DRAWINGS - RETAINING WALL
PRODUCT SPECIFICATIONS - SEWER AND WATERMAIN, INCLUDING APPURTENANCES
ASPHALT JOB MIX FORMULA(E)
CONCRETE (CURB AND SIDEWALK) MIX DESIGN(S)
GRANULAR 'A' AND 'B' SIEVE ANALYSIS'
EXCESS FILL - DUMP SITE INFORMATION AND PERMISSION LETTER
MATERIAL TESTING REPORT - ENGINEERED FILL SOURCE LETTER (RE CONTAMINANTS, ETC.)
MATERIAL TESTING REPORT - ENGINEERED FILL COMPACTION
MATERIAL TESTING REPORT - ENGINEERED FILL PLAN
MATERIAL TESTING REPORT - SUBGRADE COMPACTION/PREPARATION
MATERIAL TESTING REPORT - GRANULAR COMPACTION
MATERIAL TESTING REPORT - CONCRETE CYLINDERS
MATERIAL TESTING REPORT - ASPHALT COMPACTION
MATERIAL TESTING REPORT - ASPHALT SAMPLES
AS-BUILT SURVEY FOR EARTHWORKS QUANTITIES
CCTV OF STORM AND SANITARY SEWERS
WATERMAIN TESTING RESULTS
MANDREL, LEAKAGE, AND LOW PRESSURE AIR TESTING RESULTS

LIST OF DRAWINGS

SHEET C1	NOTES AND LEGEND
SHEET C2	EXISTING CONDITIONS, REMOVALS, AND SEDIMENT & EROSION CONTROL PLAN
SHEET C3	SITE SERVICING PLAN
SHEET C4	SITE GRADING PLAN
SHEET C5.0	STANDARD DETAILS
SHEET C5.1	STANDARD AND WATERPROOFING DETAILS

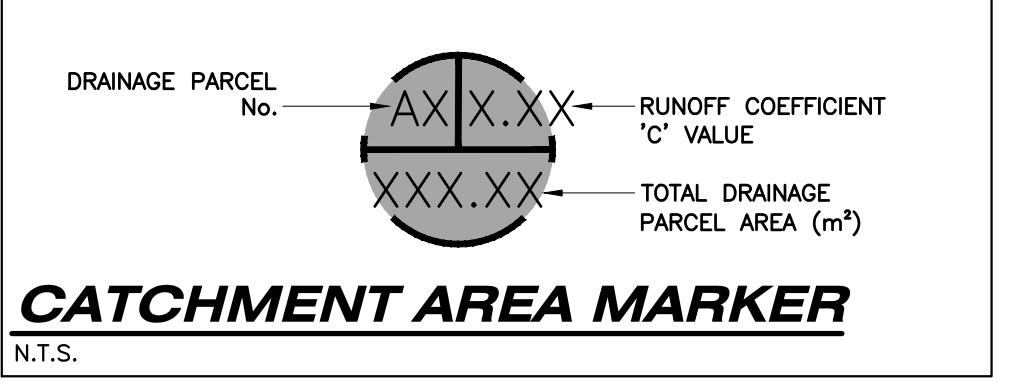
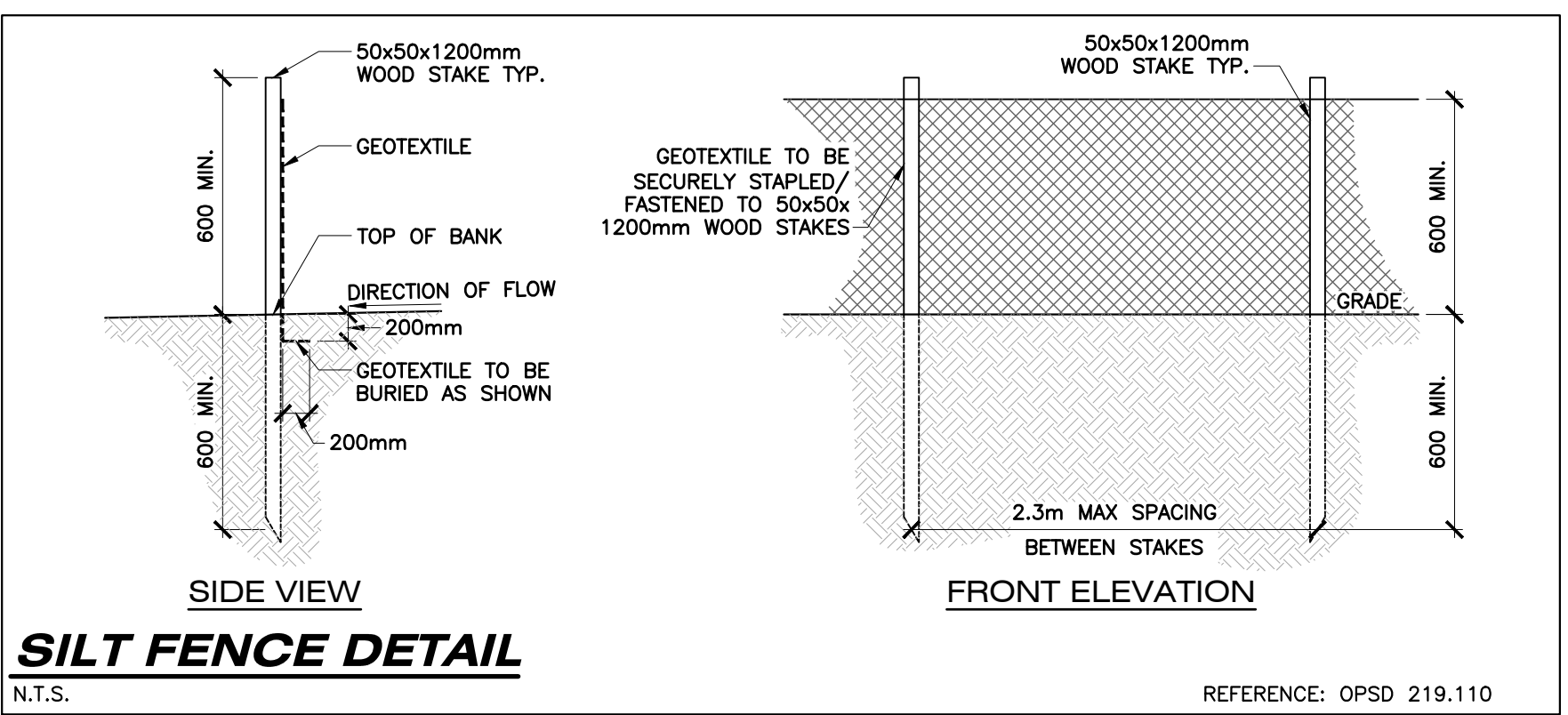
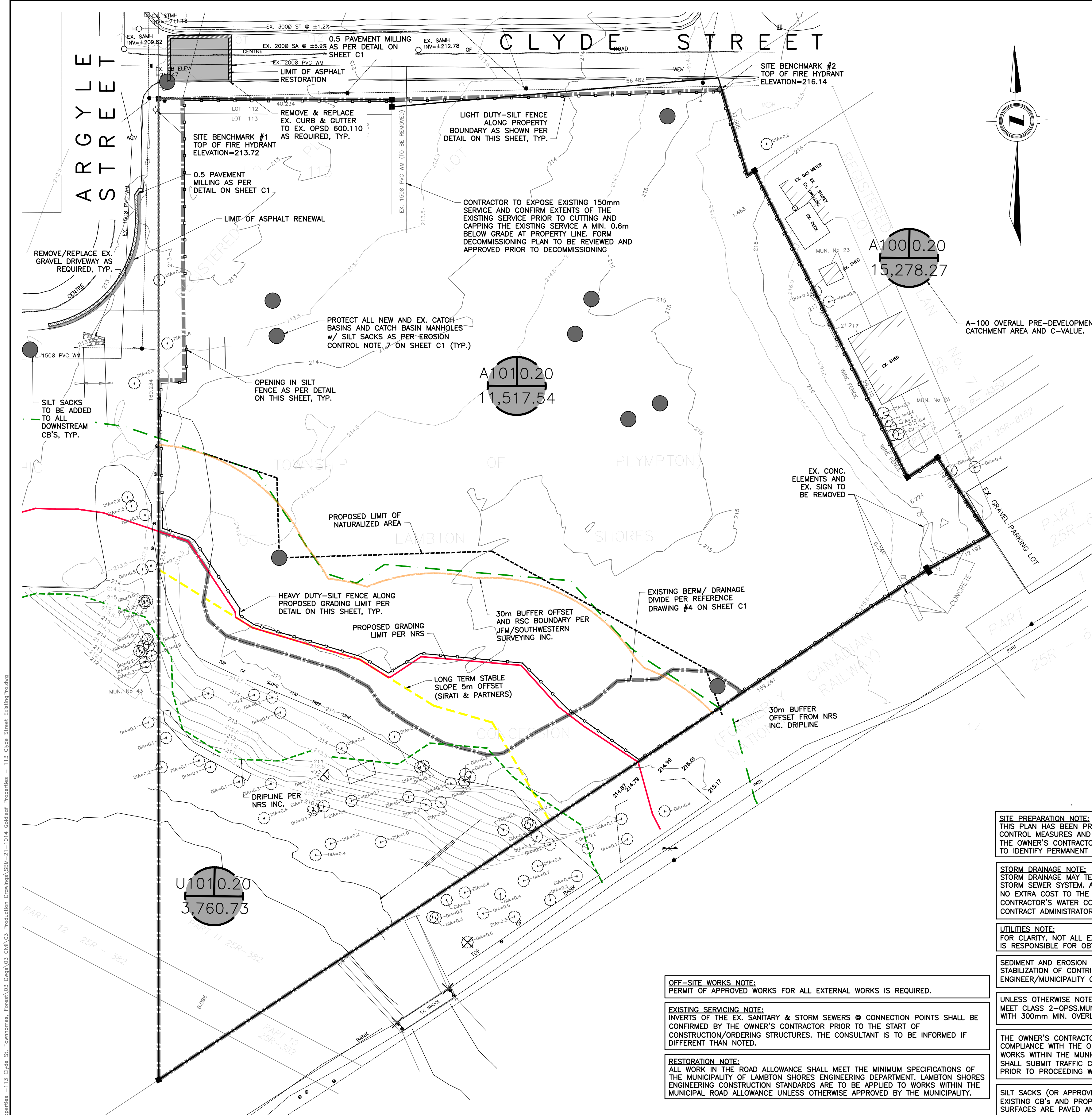

- CATCHMENT AREA MARKER**
N.T.S.
- SILT FENCE TO BE CONSTRUCTED ON PROPERTY LINE. LINE WORK IS SHOWN AS OFFSET FOR CLARITY.
- SILT FENCE TO BE CONSTRUCTED AROUND STOCKPILED SOILS AND FILL PILES.
- OWNER'S CONTRACTOR SHALL BE RESPONSIBLE FOR REGULAR MONITORING & CLEANUP OF TRACKED MUD/DEBRIS ON ADJACENT LANDS & PUBLIC ROADS TO THE SATISFACTION OF THE ENGINEER/MUNICIPALITY OF LAMBTON SHORES.
- OWNER'S CONTRACTOR SHALL TAKE ALL REASONABLE MEASURES TO AVOID MIXING TOPSOIL WITH SUBSOIL, WHERE REQUIRED FOR REUSE ON-SITE.
- TOPSOIL STOCKPILE SIZES/LOCATIONS TO BE DETERMINED IN THE FIELD. SILT FENCE SHALL BE CONSTRUCTED AT TOE OF DOWNGRADE EDGES OF TOPSOIL STOCKPILE
- ALL NATIVE FILL PLACED SHALL MEET THE REQUIREMENTS FOR ENGINEERED FILL, COMPACTED TO 100% SPMD OR AS OUTLINED IN THE GEOTECHNICAL REPORT.
- BOULEVARD AREAS AND CONCRETE SIDEWALKS DISTURBED DURING INSTALLATION OF SERVICES SHALL BE RESTORED TO MATCH EX. SURFACE WORKS NOTES ON SHEET C1, WHICHEVER IS GREATER, ALL AT NO COST TO THE MUNICIPALITY.
- DISPOSAL NOTE:
ALL ITEMS NOTED AS "TO BE REMOVED" SHALL BE DISCARDED OFF-SITE AT AN APPROVED FACILITY.
- OWNER'S CONTRACTOR TO CLEAR AND GRUB SITE PRIOR TO CONSTRUCTION AND DISPOSE OF ALL DEBRIS AND EXCESS FILL/TOPSOIL OFF-SITE AT AN APPROVED FACILITY.
- THE OWNER'S CONTRACTOR IS TO MANAGE ALL EXCESS SOIL AS PER O.REG 406/19 "ON-SITE AND EXCESS SOIL MANAGEMENT"

SEDIMENT & EROSION CONTROL MEASURES:

1. PROTECT ALL EXPOSED SURFACES AND CONTROL ALL RUNOFF DURING CONSTRUCTION.
2. SEDIMENT AND EROSION CONTROL MEASURES TO BE REMOVED AT COMPLETION OF PROJECT (FOLLOWING COMPLETION OF BASE ASPHALT AND SOD).
3. MAINTAIN EROSION CONTROL MEASURES DURING CONSTRUCTION.
4. ALL COLLECTED SEDIMENT TO BE DISPOSED OF AT AN APPROVED LOCATION.
5. MINIMIZE AREA DISTURBED DURING CONSTRUCTION.
6. ALL DEWATERING TO BE DISPOSED OF IN AN APPROVED SEDIMENTATION BASIN.
7. PROTECT ALL CATCH BASINS, MAINTENANCE HOLES AND PIPE ENDS FROM SEDIMENT INTRUSION WITH GEOTEXTILE FABRIC (TERRAFIX 270 R), SILT SACKS, OR APPROVED EQUAL.
8. PROTECT ALL CATCH BASINS, MAINTENANCE HOLES, AND PIPE ENDS WITHIN LANDSCAPE AREAS FROM SEDIMENT INTRUSION WITH STRAW BALE SEDIMENT FILTERS PER DETAIL ON THIS SHEET.
9. KEEP ALL SUMPS CLEAN DURING CONSTRUCTION.
10. PREVENT WIND-BLOWN DUST.
11. STRAW BALES TO BE USED IN LOCALIZED AREAS AS DIRECTED BY THE ENGINEER DURING CONSTRUCTION FOR WORKS WHICH ARE IN OR ADJACENT TO FLOOD LINES, FILL LINES AND HAZARDOUS SLOPES.
12. STRAW BALES TO BE TERMINATED BY ROUNDING BALES TO CONTAIN AND FILTER RUNOFF.
13. OBTAIN APPROVAL FROM THE ST. CLAIR REGION CONSERVATION AUTHORITY (SRCRA) PRIOR TO CONSTRUCTION FOR WORKS WHICH ARE IN, OR ADJACENT TO FLOOD LINES, FILL LINES AND HAZARDOUS SLOPES.
14. ALL SILT FENCING AND DETAILS ARE AT THE MINIMUM TO BE CONSTRUCTED IN ACCORDANCE WITH THE MINISTRY OF NATURAL RESOURCES GUIDELINES ON EROSION AND SEDIMENT CONTROL FOR URBAN CONSTRUCTION SITES.
15. ALL OF THE ABOVE NOTES AND ANY SEDIMENT & EROSION CONTROL MEASURES ARE AT THE MINIMUM TO BE IN ACCORDANCE WITH THE MINISTRY OF NATURAL RESOURCES GUIDELINES ON EROSION AND SEDIMENT CONTROL FOR URBAN CONSTRUCTION SITES.
16. SEDIMENT AND EROSION CONTROL MEASURES ARE TO BE INSPECTED WEEKLY OR FOLLOWING SIGNIFICANT RAINFALL EVENTS.
17. ON-SITE SEDIMENT AND EROSION CONTROL MEASURES ARE TO BE REVIEWED AND MODIFIED TO MEET THE CHANGING SITE.
18. SEDIMENT AND EROSION CONTROL MEASURES SHALL BE REPAIRED WITHOUT DELAY BY THE OWNERS CONTRACTOR AS INSTRUCTED BY THE CONTRACT ADMINISTRATOR/ENGINEER AT NO EXPENSE TO THE OWNER.

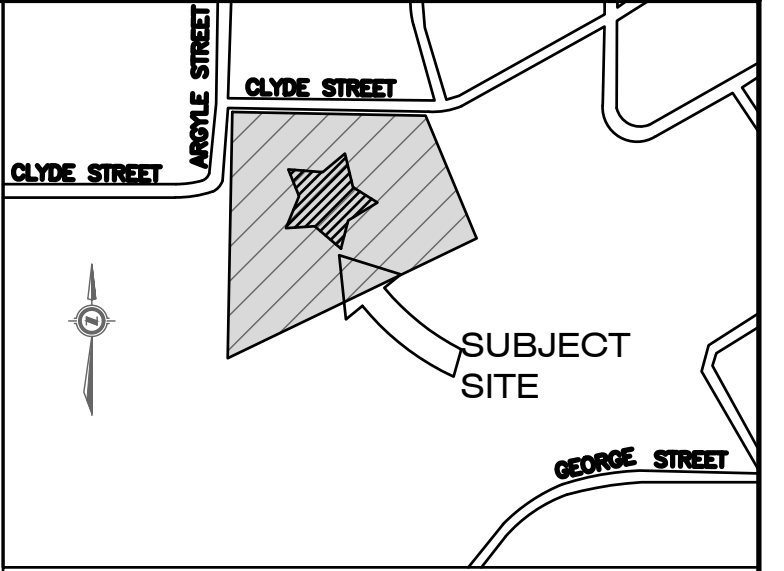

KEY PLAN
N.T.S.

LEGAL INFORMATION

PART OF
LOT 30
CONCESSION 14
IN THE
MUNICIPALITY OF
LAMBTON SHORES
(TOWN OF FOREST)
COUNTY OF LAMBTON

SITE BENCHMARK #1:
MONUMENT TYPE: TOP SPINDLE OF FIRE HYDRANT
LOCATION: NORTHWEST CORNER OF SITE.
GEODETIC ELEVATION: 213.72
(CONTRACTOR TO CONFIRM BENCHMARK ELEVATIONS)

SITE BENCHMARK #2:
MONUMENT TYPE: TOP SPINDLE OF FIRE HYDRANT
LOCATION: NORTHEAST CORNER OF SITE.
GEODETIC ELEVATION: 216.14
(CONTRACTOR TO CONFIRM BENCHMARK ELEVATIONS)

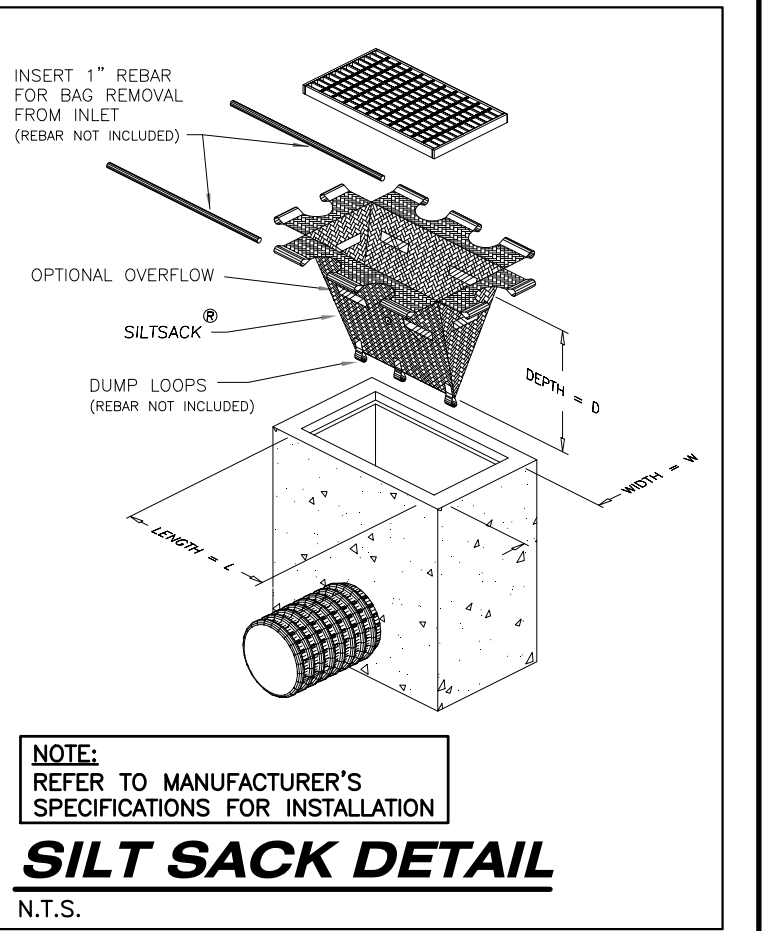

AS CONSTRUCTED SERVICES	COMPLETION	No.	REVISIONS	D/M/Y	BY	CONSULTANT
DESIGN	BG/RF	1	ISSUED FOR CLIENT REVIEW	09/02/23	BG	
DRAWN	BG	2	ISSUED FOR SITE PLAN APPROVAL 1	13/03/23	BG	
CHECKED	RF	3	ISSUED FOR SITE PLAN APPROVAL 2	25/10/23	CM	
APPROVED	RF/NGU	4	ISSUED FOR SITE PLAN APPROVAL 3	04/01/24	IAC	
DATE	08/08/2023	5	ISSUED FOR SITE PLAN APPROVAL 4	08/02/24	IAC	
		6	ISSUED FOR SITE PLAN APPROVAL 4 R1	14/02/24	IAC	
CAD	21-1014					

STRIK BALDINELLI MONIZ
PLANNING - CIVIL - STRUCTURAL - MECHANICAL - ELECTRICAL
1599 Adelaide St. N, Unit 301, London, Ontario, N5X 4E8
Tel: (519) 471-6667 Fax: (519) 471-0034
Email: sbm@sbmltd.ca

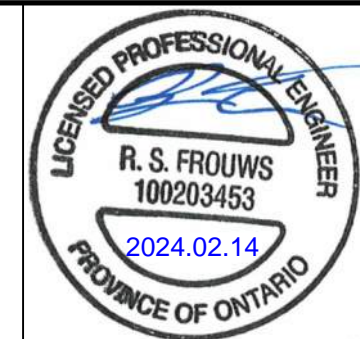

ENGINEER'S STAMP

GOLDLEAF PROPERTIES
9644 TOWNSEND LINE
KERWOOD, ON
NOM 2B0
P: 519.870.3214
E: CINDYR@MCF.LTD.CA

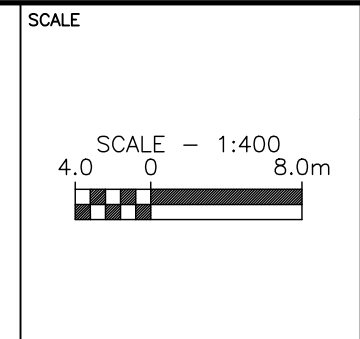

TITLE	PROJECT No.
EXISTING CONDITIONS, REMOVALS, AND SEDIMENT & EROSION CONTROL PLAN	SBM-21-1014
HICKORY CREEK ESTATES	SHEET No. C2
113 CLYDE STREET, FOREST, ON.	PLAN FILE No.

